



DEPENBROCK

REFERENZ HARBOUR CONSTRUCTION AND MARINE ENGINEERING

Quay wall refurbishment Steendiekkanal, Hamburg



The subject of the contract is the refurbishment of the western quay wall at the Steendiekkanal. The refurbishment area extends from the quay wall section (bastion) at the confluence with the Elbe, which has already been secured by a partial pre-fill, to the embankment on the south side of the west bank. The total length of the rehabilitation area is approx. 600 m. The rehabilitation comprises a water-side pre-driving of a back-anchored sheet pile wall construction with a reinforced concrete spar. The walkway and cycle path to be restored is to run along the newly created quay edge again.

Essential services:

- Preparation of the original site survey with a sounding
- Preparation of the construction site
- Removal of existing equipment with railings and waste disposal
- Dismantling of railings at the bastion with storage and re-installation
- Dismantling of street furniture with storage and reinstallation
- Construction of tree protection and securing of information boards in the area of the bastion
- Partial dismantling of backfill/embankments for clearing the pile driving route
- Construction of sheet pile wall in front
- Partial demolition of existing quay wall
- reconstruction of slope connections

Contract volume:

~ 10,8 € Mio

Contractor:

Depenbrock Ingenieurwasserbau

Client:

ReGe Hamburg

Construction time:

Feb. 2021 – approx. Nov 2022

Location:

Hamburg

Technical data / main masses:

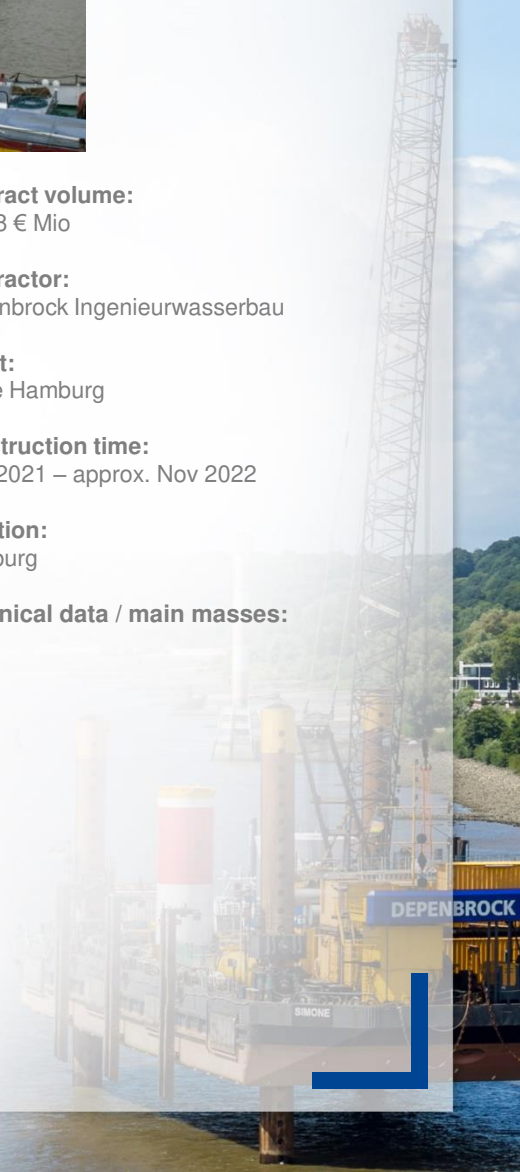



DEPENBROCK

REFERENZ HARBOUR CONSTRUCTION AND MARINE ENGINEERING

Kaimauersanierung Steendiekkanal, Hamburg

- Construction of the tension piles from the water
- Construction of the backfill of the new wall between sheet pile wall and existing quay wall
- Construction of the reinforced concrete spar
- Erection of the new railing
- Filling the cavities below the existing quay slab
- Installation of the equipment for the new sheet pile wall
- Extension of the existing outlets
- Construction of the new footpath and cycle path and adjustment of the terrain
- Removal of the temporary footpath and cycle path

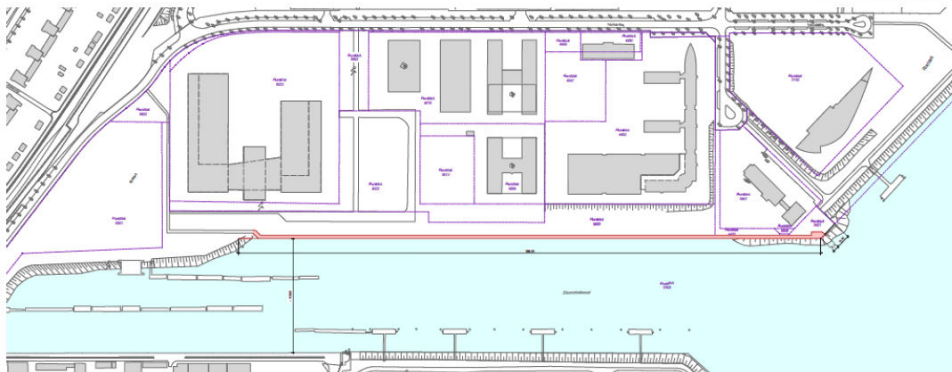

(Quelle ReGe Hamburg)

